

Samariang Aman 2

English Tudor



Mixed
Zone
Land
99-year lease

CONTACT :

019-888 7979

019-827 2755

012-888 9494

012-890 9890

Developer:



We're building your future today

HOCK SENG LEE CONSTRUCTION SDN BHD

- A wholly owned subsidiary of Hock Seng Lee Berhad
- A member of the Sarawak Housing and Real Estate Developers' Association

(328654-W)



Sales Office: Lot 1004, Jln Kwong Lee Bank, 93450 Kuching, Sarawak.

Tel: 082-337979 Fax: 082-330655 | website: www.hsl.com.my email: hslcsales@hsl.com.my

Single-Storey Terraced with Courtyard - Sublots 7-21
 Building Size: 6.0m (W) x 14.25m (L) [approx. 19ft 8in (W) x 46ft 9in (L)]
 Walled-up Area: approx. 832-847sf
 Land Size: from 4.0 pts onwards



Single storey terraced

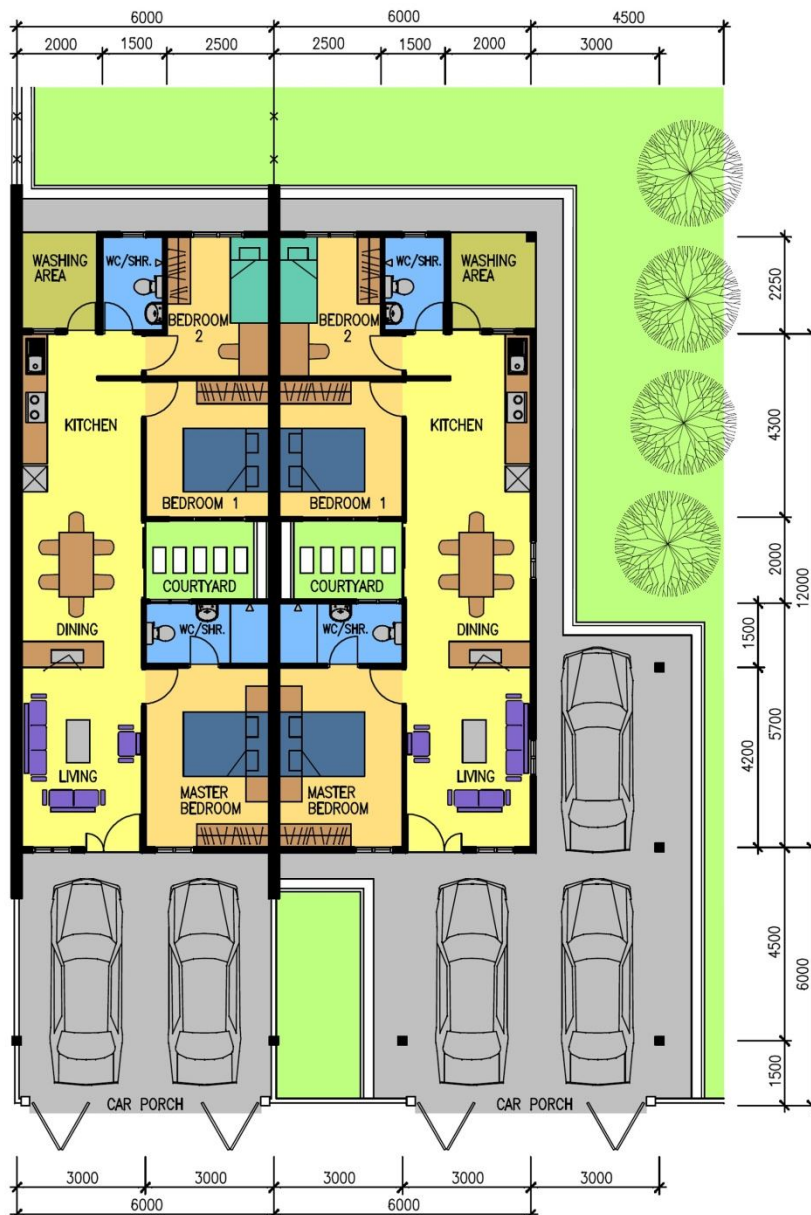

Single-Storey Semi-Detached - Sublots 1-6
 Building Size: 7.5m (W) x 14.0m (L) [approx. 24ft 7in (W) x 45ft 11in (L)]
 Walled-up Area: approx. 1,066sf
 Land Size: from 8.0 pts onwards



Single storey semi-detached



- Single Storey Terraced
- Single Storey Semi-Detached

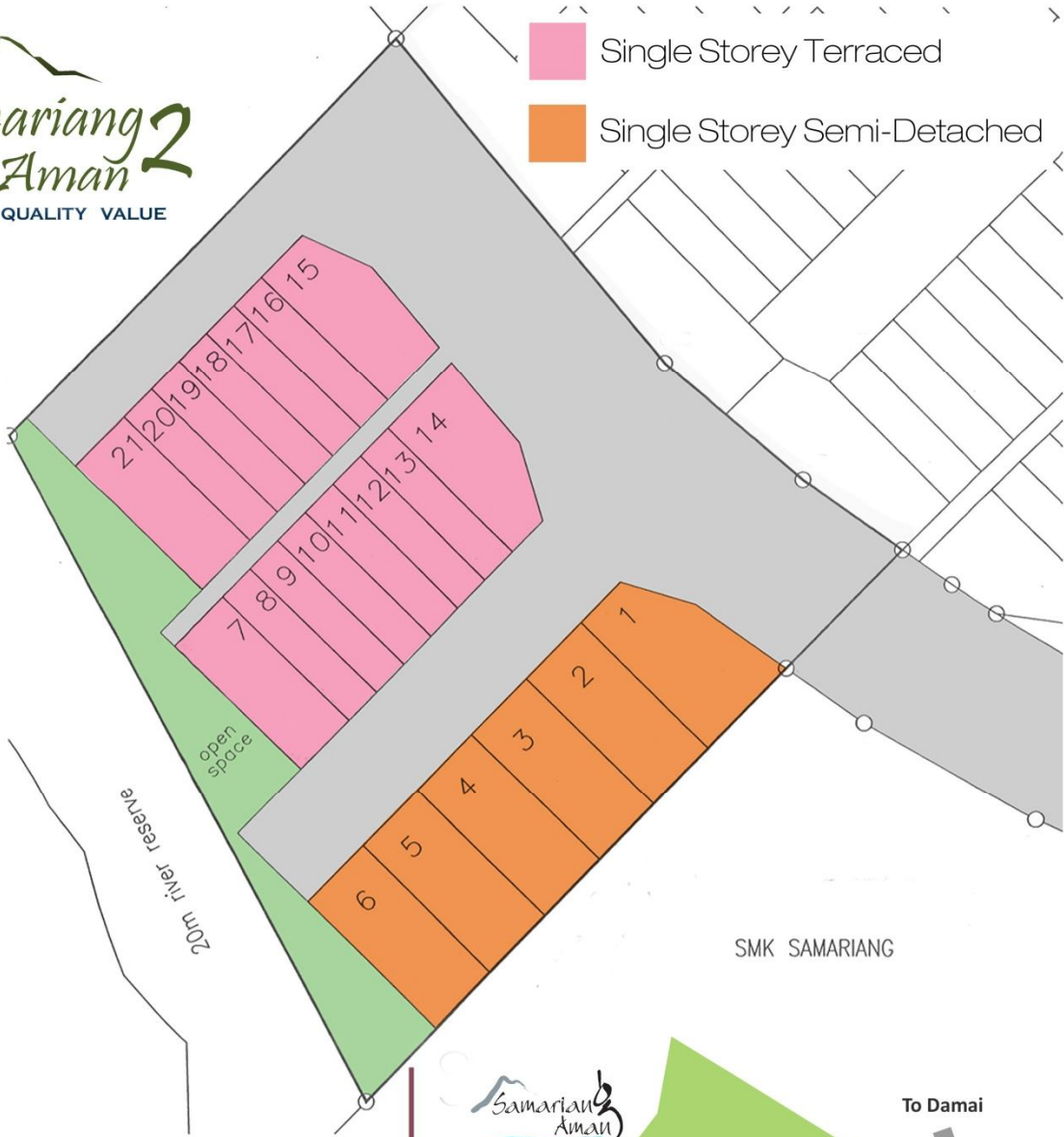

Developer's License No.:
L1721/KP/HD/01/654
Validity : 9/12/2011 - 25/9/2012

Advertisement & Sales Permit :
P1624/KP/HD/01/654
Validity : 9/12/2011 - 25/9/2012

Expected Date of Completion :
24 months from date of S & P

Tenure of Land :
99 years leasehold (mixed zone land)

Building Plan No.: DBKU/56/2010 &
DBKU/57/2010 | Approval Authority: DBKU
SPA Approval No.: P/1D/104-07

SHEDA Membership No. : SHEDA/179/00

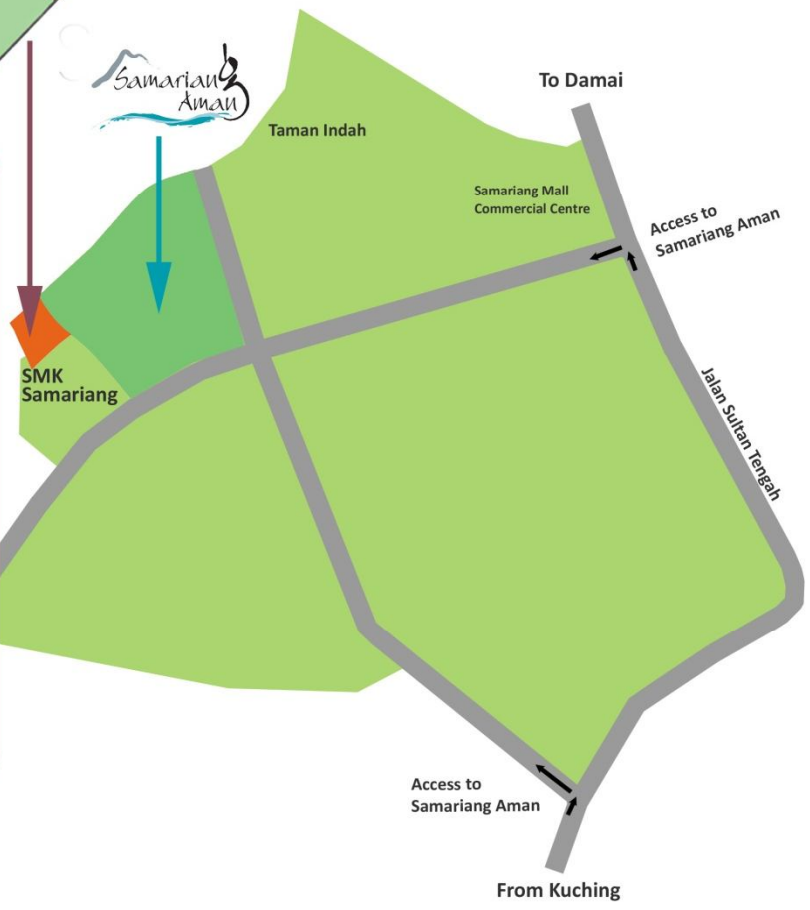

Note: Illustrations are an artist's impression only. The information and plans are subject to change as may be required by the authorities or architect and cannot form part of an offer or contract. While every care has been taken in the preparation of this brochure, the developer or agent cannot be held responsible for any inaccuracy.